

### Meade Customer Service

If you have a question concerning your Meade Polaris Motor Drive, contact the Meade Instruments Customer Service Department at:

**Telephone:** (800) 626-3233.

Customer Service hours are 7:00 AM to 5:00 PM, Pacific Time, Monday through Friday. In the unlikely event that your Polaris Motor Drive requires factory servicing or repairs, write or call the Meade Customer Service Department first, before returning the motor drive to the factory, giving full particulars as to the nature of the problem, as well as your name, address, and daytime telephone number. The great majority of servicing issues can be resolved by telephone, avoiding return of the motor drive to the factory. If factory service is required, you will be assigned a Return Goods Authorization (RGA) number prior to return.

### MEADE LIMITED WARRANTY

Every Meade telescope, spotting scope, and telescope accessory is warranted by Meade Instruments Corp. ("Meade") to be free of defects in materials and workmanship for a period of ONE YEAR from the date of original purchase in the U.S.A. and Canada. Meade will repair or replace a product, or part thereof, found by Meade to be defective, provided the defective part is returned to Meade, freight-prepaid, with proof of purchase. This warranty applies to the original purchaser only and is non-transferable. Meade products purchased outside North America are not included in this warranty, but are covered under separate warranties issued by Meade international distributors.

**RGA Number Required:** Prior to the return of any product or part, a Return Goods Authorization (RGA) number **must** be obtained from Meade by writing, or calling (800) 626-3233. Each returned part or product must include a written statement detailing the nature of the claimed defect, as well as the owner's name, address, and phone number.

This warranty is not valid in cases where the product has been abused or mishandled, where unauthorized repairs have been attempted or performed, or where depreciation of the product is due to normal wear-and-tear. Meade specifically disclaims special, indirect, or consequential damages or lost profit which may result from a breach of this warranty. Any implied warranties which cannot be disclaimed are hereby limited to a term of one year from the date of original retail purchase. This warranty gives you specific rights. You may have other rights which vary from state to state. Meade reserves the right to change product specifications or to discontinue products without notice.



For 606000 rev001  
10/14



## MEADE INSTRUMENTS

### Polaris Motor Drive User Guide

### How to Install the Battery

1. Unscrew the 2 black thumbscrews located on the front panel (under the N/S switch and the slender knob).
2. Separate the motor drive from the front panel cover.
3. Install the 9V battery onto the battery connector.
4. Carefully place the battery between the rubber cover and motor, which is located behind the electronic board.
5. Reassemble the front panel with motor drive and tighten the black thumbscrews.

### How to Operate your Polaris Motor Drive

1. The motor drive comes equipped with a 9V battery. The LED light on the unit indicates when power is on. Use on/off switch to turn off power and conserve the battery when not in use.
2. This motor is designed to compensate for the earth's rotation. Its rotation speed matches the earth's rotation rate for stars to appear stationary in telescope eyepiece. The slender plastic knob allows for fine adjustment to the tracking rate. Use this to adjust the motor speed during observing. For the motor drive to properly compensate for the earth's rotation, your telescope mount must be polar-aligned and the altitude set to your local latitude.
3. The N/S switch is used to control direction of motor tracking. Use the "S" setting for observing in the southern hemisphere. Users in the northern hemisphere should set the setting to "N".

## How to Install the Polaris Motor Drive on your Polaris 70/80

1. Remove R.A. control cable from left side of mount.
2. Loosen set screw on end of the flexible motor coupler. Slide the open end of the flexible motor coupler over the R.A. axis worm gear as shown in image 2. Tighten thumb screw on the **flat side** of the shaft.
3. Use included hex key to remove hex screw from altitude axis.
4. Fasten motor drive mounting bracket to altitude axis using 4mm hex screw. Leave screw loose enough to allow motor to rotate slightly.
5. Tighten set screw to hold the flexible motor coupler onto R.A. worm gear shaft.
6. Make sure that all the screws are tightened and the motor drive is secured.

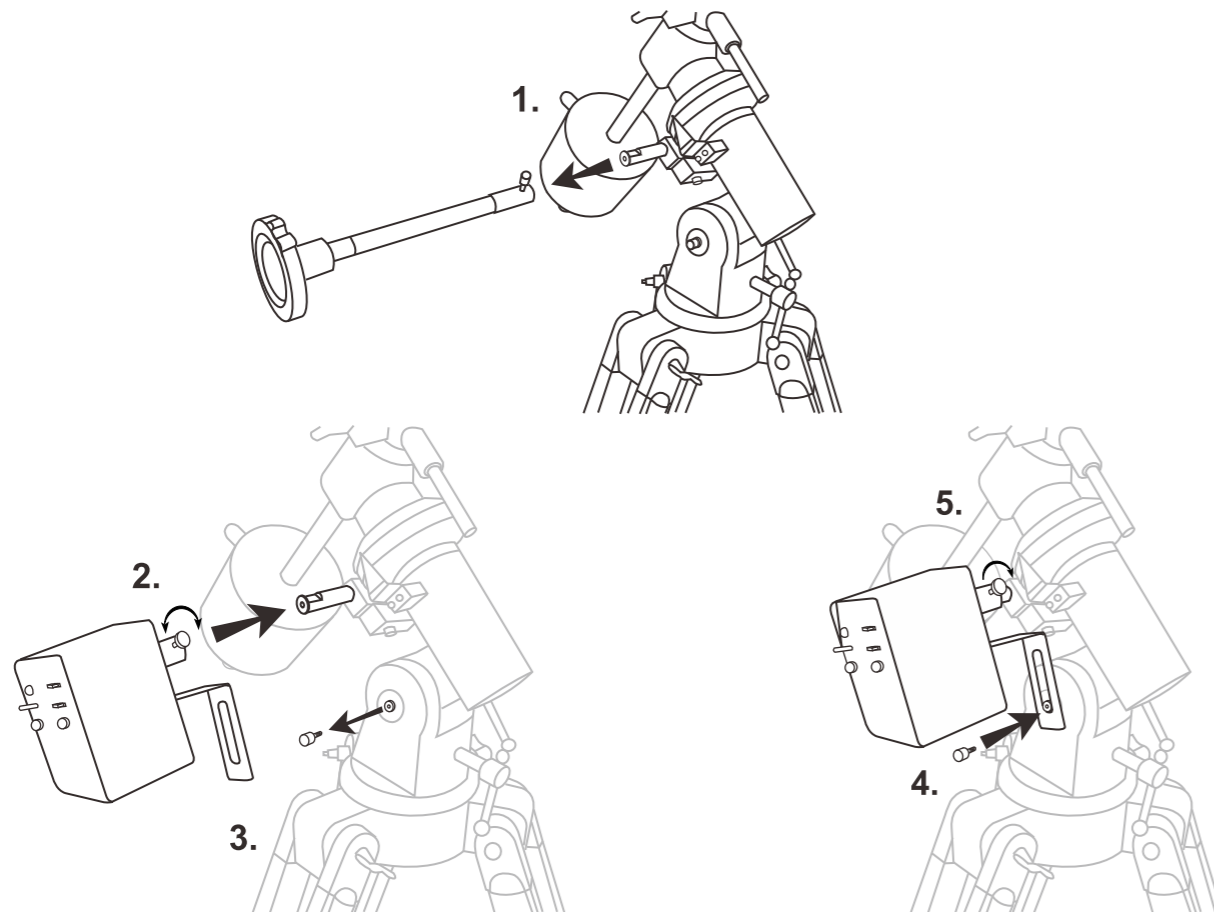

## How to Install the Polaris Motor Drive on your Polaris 90/114/127/130

1. Remove R.A. control cable from right side of mount.
2. Loosen set screw on end of the flexible motor coupler. Slide the open end of the flexible motor coupler over the R.A. axis worm gear shaft. Lightly tighten thumb screw on the **flat side** of the shaft.
3. Use included hex key to remove hex screw from altitude axis. The screw may be located on the right side of the mount.
4. Fasten motor drive mounting bracket to altitude axis using 4mm hex screw. In this configuration, the motor drive will be mounted to the mount with the text upside down.
5. Now firmly tighten set screw to hold the flexible motor coupler onto R.A. worm gear shaft.

